

25-OCT-2021 09:50
 S:\Contracts\6) Proposed Resurfacing\DA00516-Cracksealing\Design Files\2022CPT.01.12.10152.1.DIDD...sh2.dgn
 \$\$\$USERNAME\$\$\$

CONTRACT: DA00516 **WBS#: 2022CPT.01.12.10082.1, ETC.**

STATE OF NORTH CAROLINA
 DIVISION OF HIGHWAYS

CAMDEN COUNTY

STATE	STATE PROJECT REFERENCE NO.	SHEET NO.
N.C.	2022CPT.01.12.10082.1, ETC.	2
STATE PROJ. NO.	F.A. PROJ. NO.	DESCRIPTION
2022CPT.01.12.10152.1		PE, CONST.
2022CPT.01.12.20152.1		PE, CONST.

TYPE OF WORK: CRACKSEALING

LOCATION:

- MAP 3 - US 17 NB FROM PASQUOTANK CO LINE TO VA STATE LINE
- MAP 4 - US 17 SB FROM VA STATE LINE TO PASQUOTANK CO LINE
- MAP 15 - SR 1138 FROM SR 1132 TO NC 343
- MAP 16 - SR 1162 FROM SR 1100 TO SR 1163
- MAP 17 - SR 1165 FROM CUL-DE-SAC TO NC 343
- MAP 18 - SR 1221 FROM DEAD END TO SR 1219
- MAP 19 - SR 1228 FROM DEAD END TO SR 1232
- MAP 20 - SR 1229 FROM EOP TO SR 1224

- MAP 21 - SR 1231 FROM US 17 TO SR 1233
- MAP 22 - SR 1234 FROM DEAD END TO SR 1224
- MAP 23 - SR 1235 FROM DEAD END TO SR 1224
- MAP 24 - SR 1238 FROM DEAD END TO SR 1224
- MAP 25 - SR 1239 FROM DEAD END TO SR 1224
- MAP 26 - SR 1249 FROM DEAD END TO SR 1224
- MAP 27 - SR 1251 FROM PASQUOTANK CO LINE TO US 17

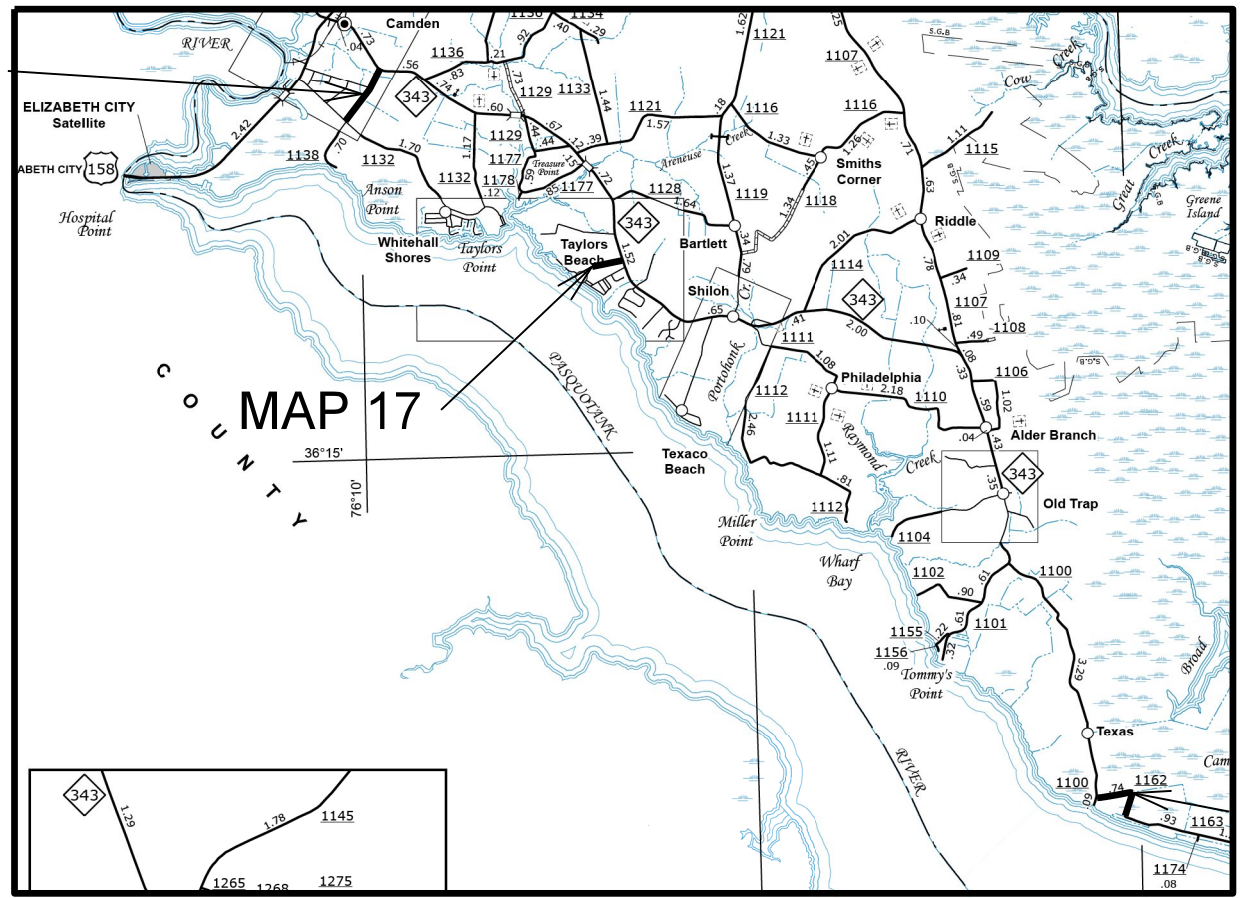
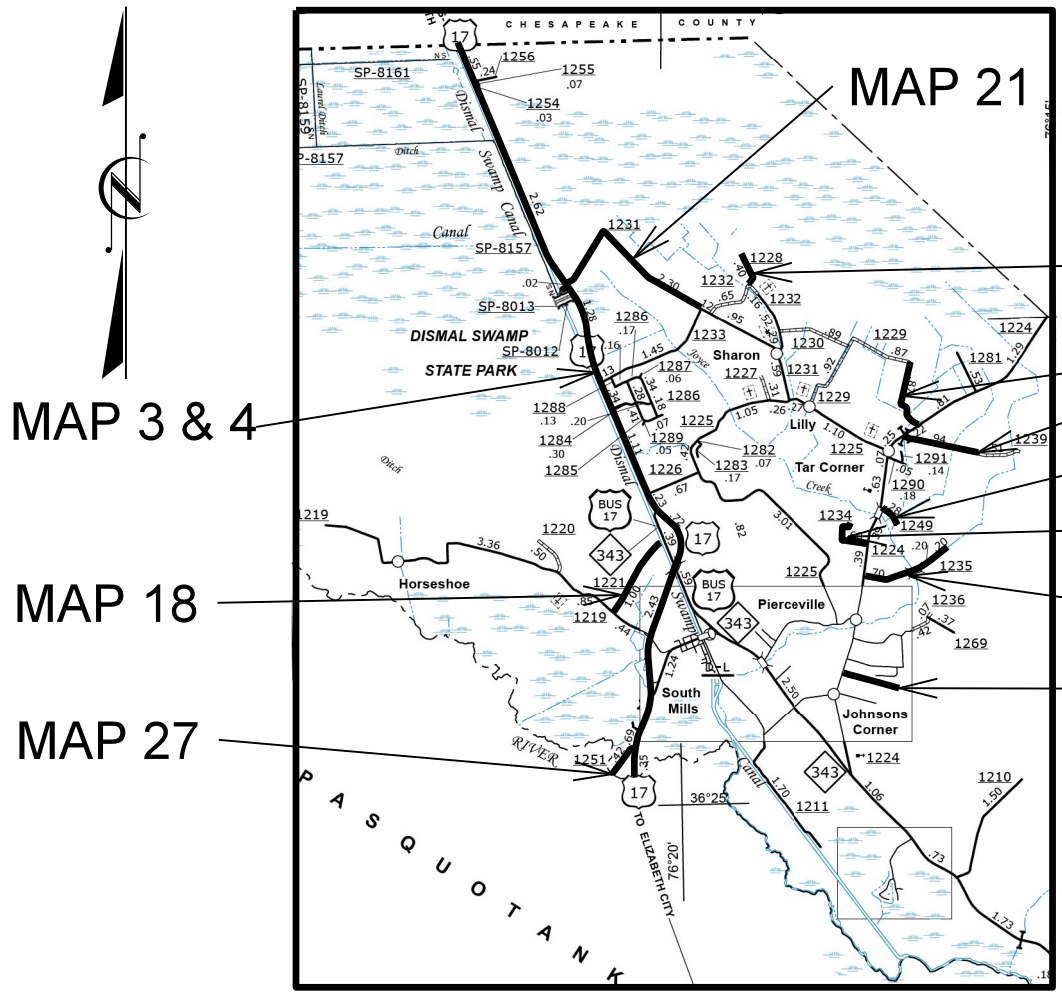

MAP 3 & 4
 MAP 18
 MAP 27

MAP 15
 MAP 19
 MAP 20
 MAP 25
 MAP 26
 MAP 22
 MAP 23
 MAP 24

MAP 16

GRAPHIC SCALES

NTS

PROJECT LENGTH	
MAP 5 = 0.40 MILES	MAP 21 = 2.30 MILES
MAP 6 = 1.18 MILES	MAP 22 = 0.60 MILES
MAP 15 = 0.74 MILES	MAP 23 = 1.10 MILES
MAP 16 = 0.74 MILES	MAP 24 = 0.70 MILES
MAP 17 = 0.37 MILES	MAP 25 = 0.85 MILES
MAP 18 = 1.00 MILES	MAP 26 = 0.28 MILES
MAP 19 = 0.40 MILES	MAP 27 = 0.44 MILES
MAP 20 = 0.93 MILES	

Prepared in the Office of:
DIVISION OF HIGHWAYS
 113 Airport Dr., Edenton NC, 27932

2018 STANDARD SPECIFICATIONS

W. B. HOBBS, PE
 DIVISION PROJECT TEAM LEAD

C. E. SLACHTA
 DIVISION CONTRACT ENGINEER

S. P. FENWICK, PLS
 DIVISION DESIGN ENGINEER

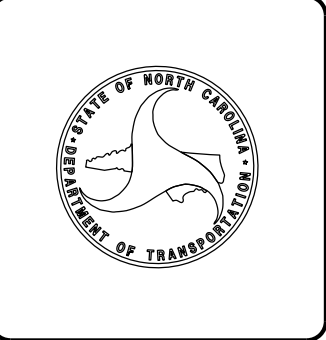

28-OCT-2021 10:28 S:\Contractors\616\Proposed Resurfacing\DA00516 - District I & III Cracksealing (2021-2022)\Design Files\2022CPT.01.12.10082.1.DIDDC.sh2.dgn
 \$\$\$USERNAME\$\$\$

CONTRACT: DA00516 **WBS#: 2022CPT.01.12.10082.1, ETC.**

STATE OF NORTH CAROLINA
 DIVISION OF HIGHWAYS

CHOWAN COUNTY

TYPE OF WORK: CRACKSEALING

LOCATION:

- MAP 28 - SR 1149 FROM DEAD END TO SR 1146
- MAP 29 - SR 1156 FROM SR 1155 TO SR 1159
- MAP 30 - SR 1159 FROM SR 1155 TO SR 1155
- MAP 31 - SR 1164 FROM SR 1148 TO SR 1149
- MAP 32 - SR 1205 FROM SR 1206 TO SR 1204

- MAP 33 - SR 1206 FROM SR 1200 TO NC 32
- MAP 34 - SR 1211 FROM SR 1210 TO SR 1207
- MAP 35 - SR 1218 FROM SR 1217 TO SR 1222
- MAP 36 - SR 1237 FROM DEAD END TO SR 1218

STATE	STATE PROJECT REFERENCE NO.	SHEET NO.
N.C.	2022CPT.01.12.10082.1, ETC.	2A
STATE PROJ. NO.	F.A. PROJ. NO.	DESCRIPTION
2022CPT.01.12.20212.1		PE, CONST.

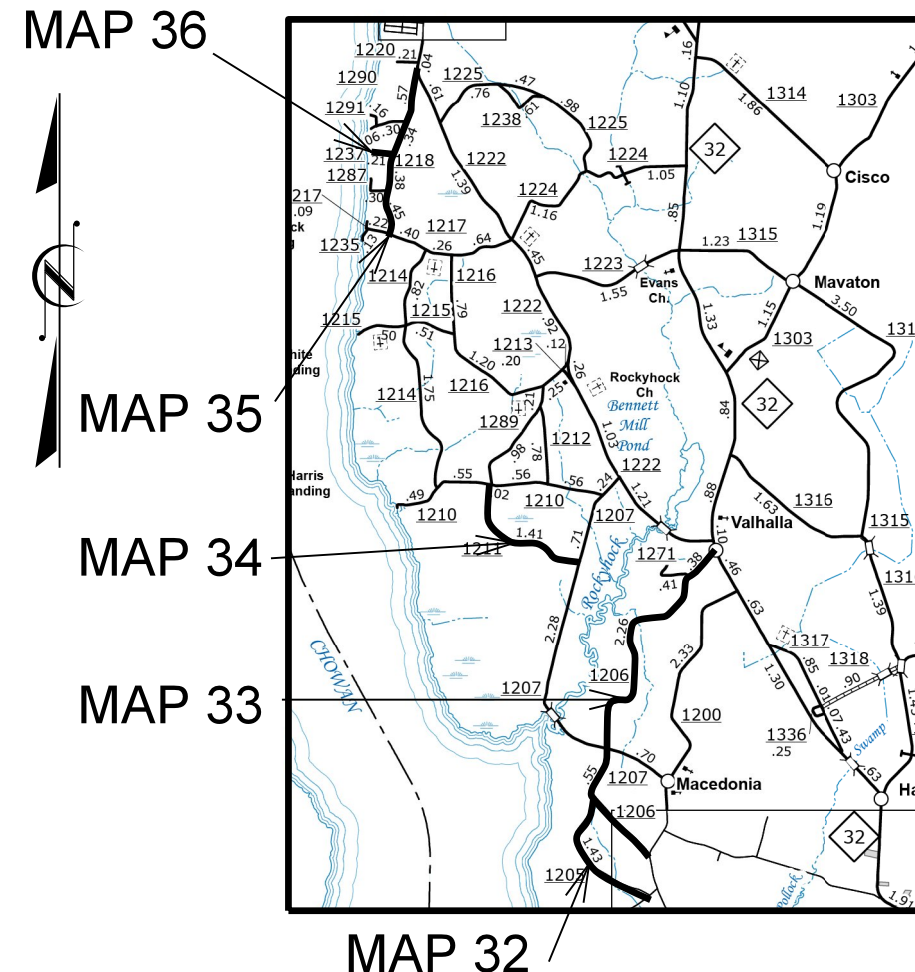
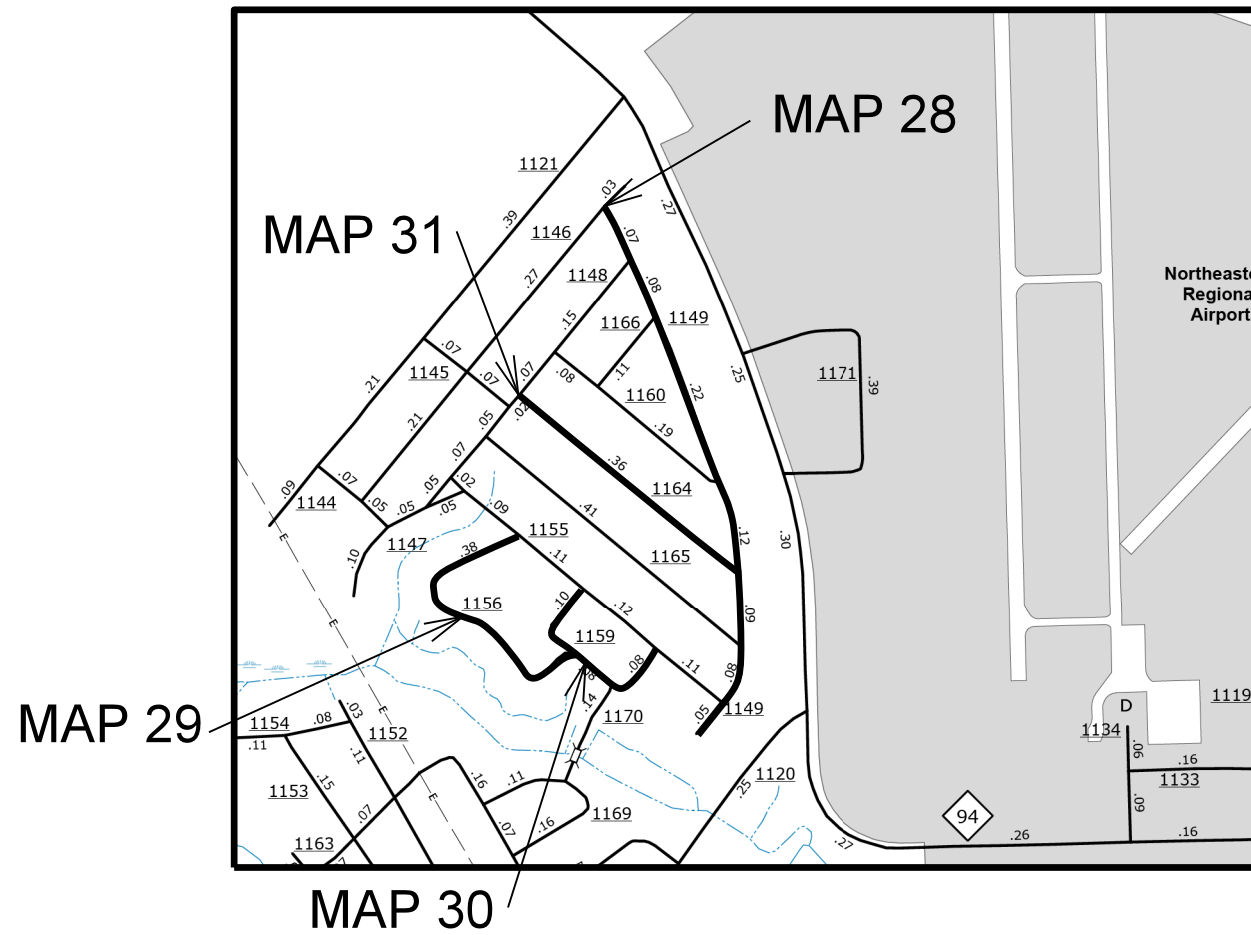

GRAPHIC SCALES

NTS

PROJECT LENGTH

MAP 28	= 0.71 MILES
MAP 29	= 0.38 MILES
MAP 30	= 0.25 MILES
MAP 31	= 0.36 MILES
MAP 32	= 1.43 MILES
MAP 33	= 4.00 MILES
MAP 34	= 1.41 MILES
MAP 35	= 1.74 MILES
MAP 36	= 0.21 MILES

Prepared in the Office of:
DIVISION OF HIGHWAYS
 113 Airport Dr., Edenton NC, 27932

W. B. HOBBS, PE
 DIVISION PROJECT TEAM LEAD

C. E. SLACHTA
 DIVISION CONTRACT ENGINEER

S. P. FENWICK, PLS
 DIVISION DESIGN ENGINEER

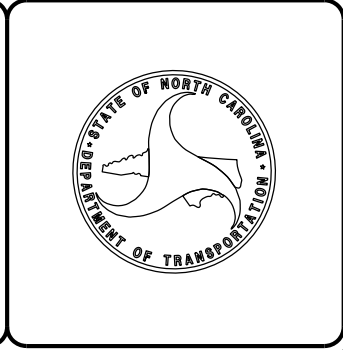

25-OCT-2021 10:01
 S:\Contracts\6) Proposed Resurfacing\DA00516-Cracksealing\Design Files\2022CPT.01.12.10272.1.DIDD0C_sn3.dgn
 \$\$\$USERNAME\$\$\$

CONTRACT: DA00516 **WBS#: 2022CPT.01.12.10082.1, ETC.**

STATE OF NORTH CAROLINA
 DIVISION OF HIGHWAYS

CURRITUCK COUNTY

STATE	STATE PROJECT REFERENCE NO.	SHEET NO.
N.C.	2022CPT.01.12.10082.1, ETC.	3
STATE PROJ. NO.	F.A. PROJ. NO.	DESCRIPTION
2022CPT.01.12.10272.1		PE, CONST.
2022CPT.01.12.20272.1		PE, CONST.

LOCATION:

- MAP 5 - NC 136 FROM SR 1131 TO SR 1135
- MAP 6 - NC 136 FROM US 158 TO SR 1131
- MAP 37 - SR 1121 FROM SR 1118 TO US 158
- MAP 38 - SR 1137 FROM DEAD END TO SR 1140
- MAP 39 - SR 1245 FROM DEAD END TO NC 168

TYPE OF WORK: CRACKSEALING

- MAP 40 - SR 1246 FROM NC 168 TO US 158
- MAP 41 - SR 1269 FROM DEAD END TO NC 168
- MAP 42 - SR 1346 FROM CUL-DE-SAC TO SR 1203
- MAP 43 - SR 1347 FROM CUL-DE-SAC TO NC 168
- MAP 44 - SR 1401 FROM CUL-DE-SAC TO NC 136

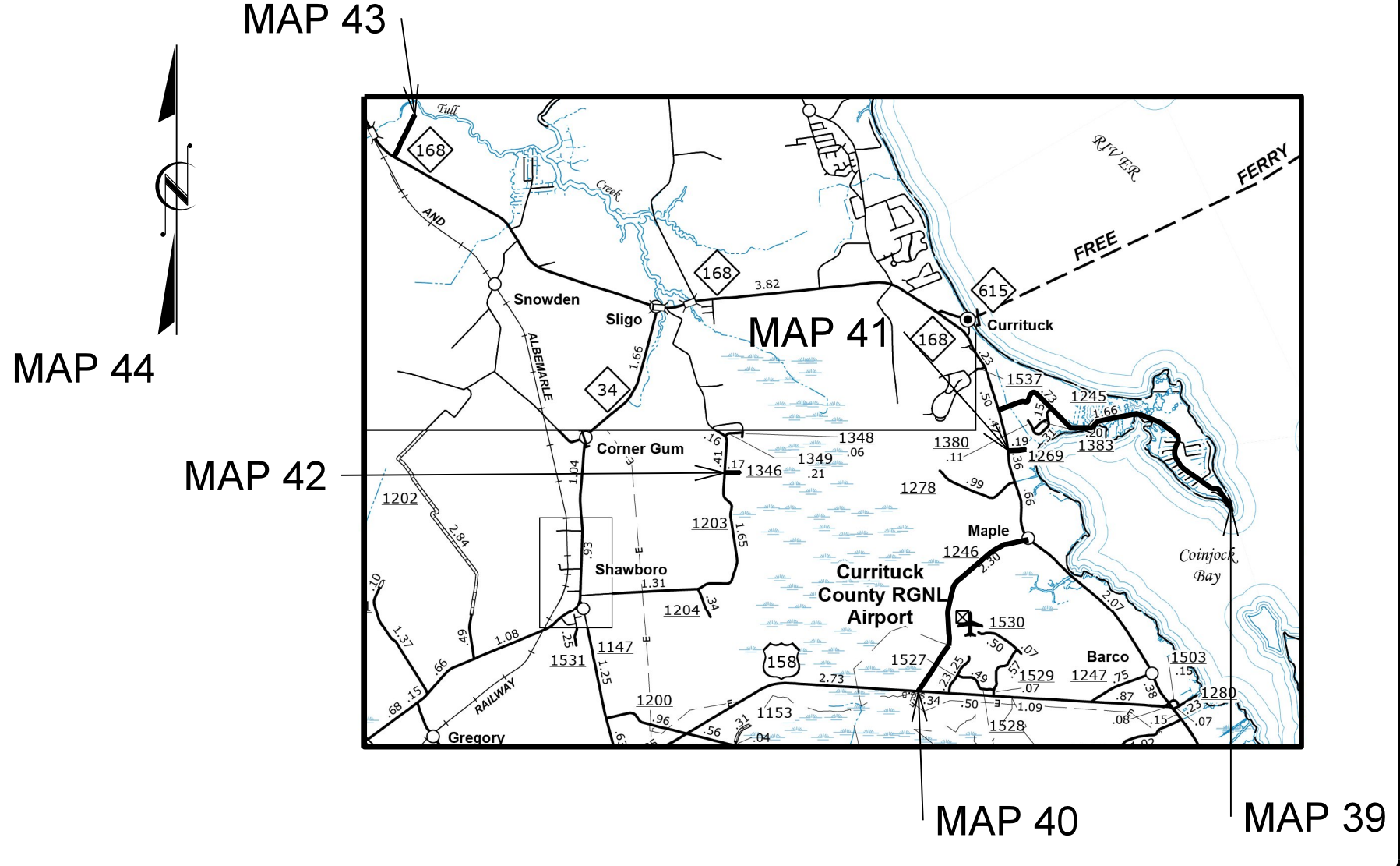
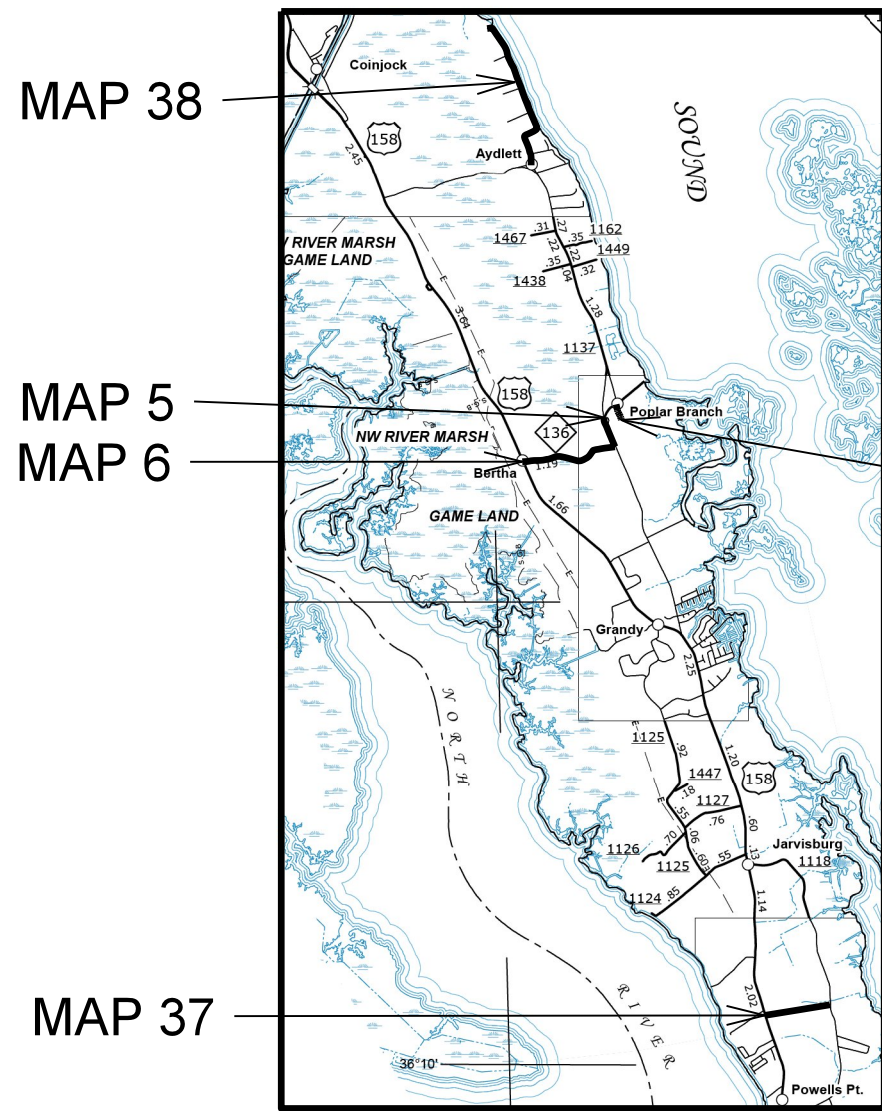

GRAPHIC SCALES

NTS

PROJECT LENGTH	
MAP 5 = 0.40 MILES	MAP 40 = 2.30 MILES
MAP 6 = 1.18 MILES	MAP 41 = 0.24 MILES
MAP 37 = 0.80 MILES	MAP 42 = 0.17 MILES
MAP 38 = 1.96 MILES	MAP 43 = 0.53 MILES
MAP 39 = 3.42 MILES	MAP 44 = 0.22 MILES

Prepared in the Office of:
DIVISION OF HIGHWAYS
 113 Airport Dr., Edenton NC, 27932

2018 STANDARD SPECIFICATIONS

W. B. HOBBS, PE
 DIVISION PROJECT TEAM LEAD

C. E. SLACHTA
 DIVISION CONTRACT ENGINEER

S. P. FENWICK, PLS
 DIVISION DESIGN ENGINEER

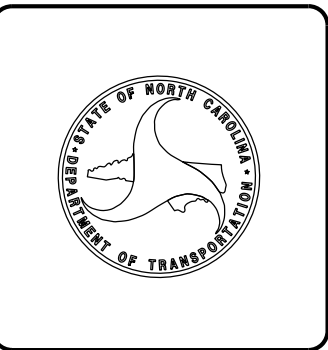

STATE	STATE PROJECT REFERENCE NO.	SHEET NO.
N.C.	2022CPT.01.12.10082.1, ETC.	4
STATE PROJ. NO.	F.A. PROJ. NO.	DESCRIPTION
2022CPT.01.12.10282.1		PE, CONST.
2022CPT.01.12.20282.1		PE, CONST.

STATE OF NORTH CAROLINA
DIVISION OF HIGHWAYS

DARE COUNTY

TYPE OF WORK: CRACKSEALING

LOCATION:

- MAP 7 – US 64 FROM US 264 TO VIRGINIA DARE BRIDGE
- MAP 8 – US 64 BUS FROM US 64 TO MANNS HARBOR BRIDGE
- MAP 9 – US 64 BUS FROM MANNS HARBOR BRIDGE TO SR 1118
- MAP 46 – SR 1207 FROM SR 1208 TO SR 1206
- MAP 47 – SR 1211 FROM SR 1208 TO DEAD END

- MAP 48 – SR 1212 FROM SR 1213 TO SR 1206
- MAP 49 – SR 1214 FROM CUL-DE-SAC TO SR 1213
- MAP 50 – SR 1215 FROM SR 1206 TO DEAD END
- MAP 51 – SR 1216 FROM BEACON DRIVE TO SR 1206
- MAP 82 – SR 1533 FROM DEAD END TO SR 1208

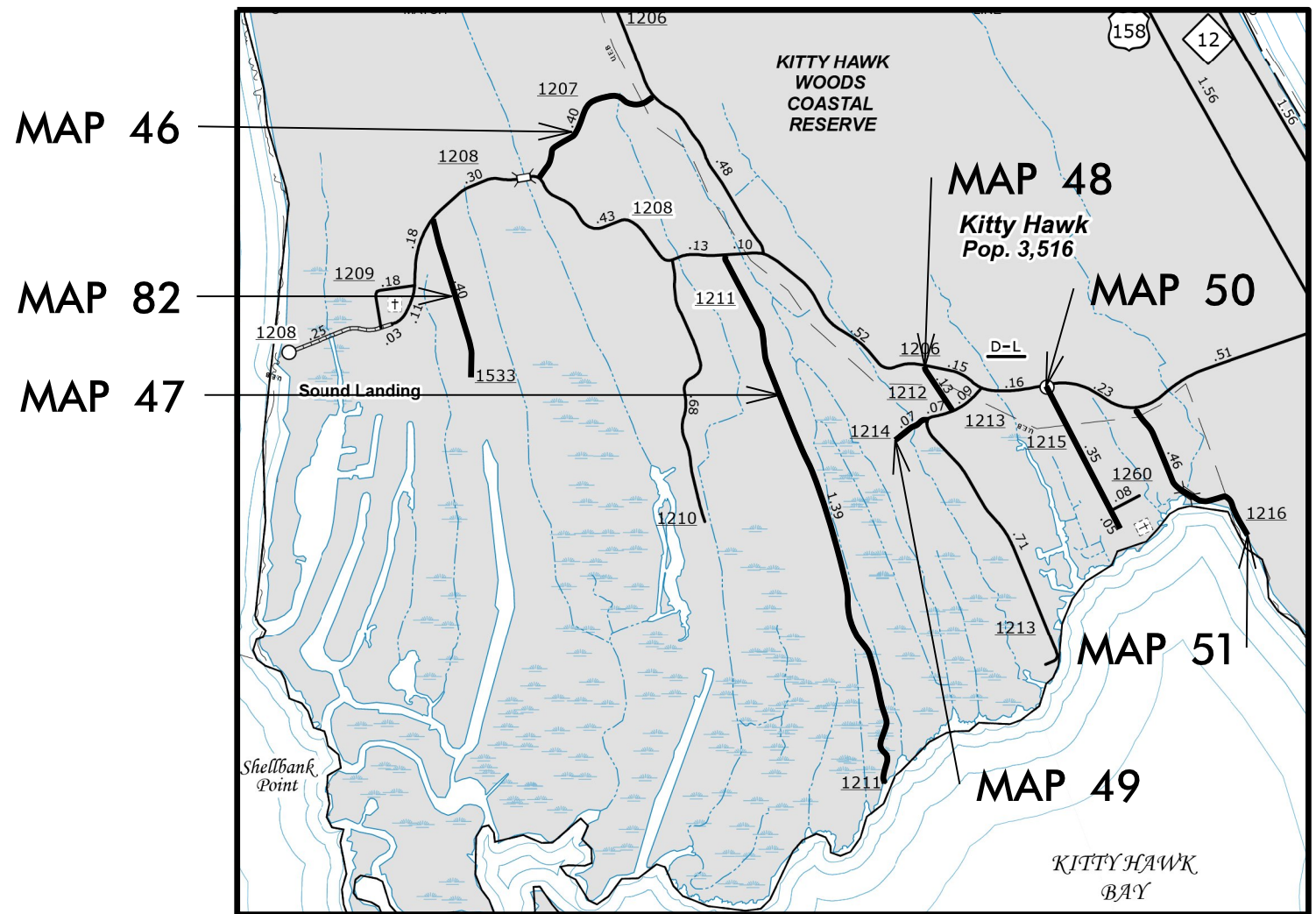
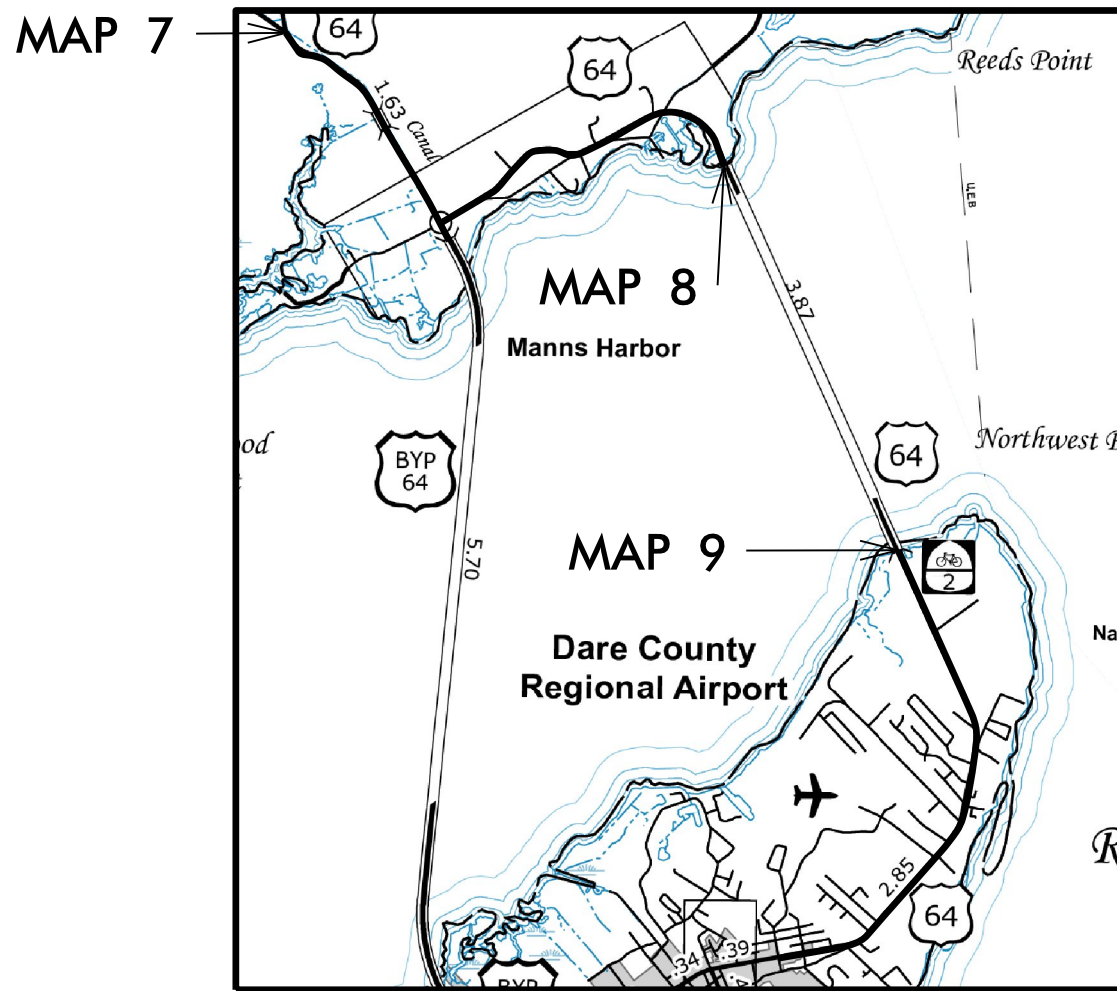

GRAPHIC SCALES

NTS

PROJECT LENGTH

MAP 7 = 2.03 MILES	MAP 48 = 0.13 MILES
MAP 8 = 2.22 MILES	MAP 49 = 0.09 MILES
MAP 9 = 3.45 MILES	MAP 50 = 0.39 MILES
MAP 46 = 0.43 MILES	MAP 51 = 0.50 MILES
MAP 47 = 1.25 MILES	MAP 82 = 0.40 MILES

Prepared in the Office of:
DIVISION OF HIGHWAYS
113 Airport Dr., Edenton NC, 27932

2018 STANDARD SPECIFICATIONS

W. B. HOBBS, PE
DIVISION PROJECT TEAM LEAD

C. E. SLACHTA
DIVISION CONTRACT ENGINEER

S. P. FENWICK, PLS
DIVISION DESIGN ENGINEER

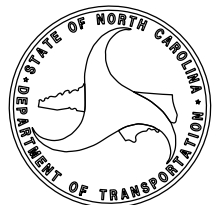

15-OCT-2021 08:28
 S:\Contracts\6) Proposed Resurfacing\DA00516-Cracksealing\Design Files\2022CPT.01.12.10282.1.DIDDC_sn4.dgn
 \$\$\$USERNAME\$\$\$
CONTRACT: DA00516
WBS#: 2022CPT.01.12.10082.1, ETC.

25-OCT-2021 10:14
 S:\Contracts\6) Proposed Resurfacing\DA00516-Cracksealing\Design Files\2022CPT.01.12.20282.1.DIDD...sh6.dgn
 \$\$\$USERNAME\$\$\$

CONTRACT: DA00516 **WBS#: 2022CPT.01.12.10082.1, ETC.**

STATE OF NORTH CAROLINA
 DIVISION OF HIGHWAYS

DARE COUNTY

STATE	STATE PROJECT REFERENCE NO.	SHEET NO.
N.C.	2022CPT.01.12.10082.1, ETC.	6
STATE PROJ. NO.	F.A. PROJ. NO.	DESCRIPTION
2022CPT.01.12.20282.1		PE, CONST.

TYPE OF WORK: CRACKSEALING

- LOCATION:**
- MAP 53 - SR 1409 FROM NC 12 TO SR 1409
 - MAP 54 - SR 1410 FROM CUL-DE-SAC TO CHRISTOPHER DR
 - MAP 55 - SR 1417 FROM NC 12 TO CUL-DE-SAC
 - MAP 56 - SR 1425 FROM NC 12 TO CUL-DE-SAC
 - MAP 67 - SR 1469 FROM CUL-DE-SAC TO NC 12
 - MAP 68 - SR 1473 FROM CUL-DE-SAC TO DEAD END
 - MAP 69 - SR 1474 FROM NC 12 TO BUFFELL HEAD RD
 - MAP 70 - SR 1475 FROM NC 12 TO BUFFELL HEAD RD

- MAP 71 - SR 1476 FROM NC 12 TO BUFFELL HEAD RD
- MAP 72 - SR 1477 FROM NC 12 TO BUFFELL HEAD RD
- MAP 73 - SR 1478 FROM NC 12 TO BUFFELL HEAD RD
- MAP 76 - SR 1479 FROM NC 12 TO BUFFELL HEAD RD
- MAP 77 - SR 1484 FROM NC 12 TO CUL-DE-SAC
- MAP 80 - SR 1518 FROM NC 12 TO SR 1519
- MAP 81 - SR 1519 FROM PAVEMENT JOINT TO DEAD END

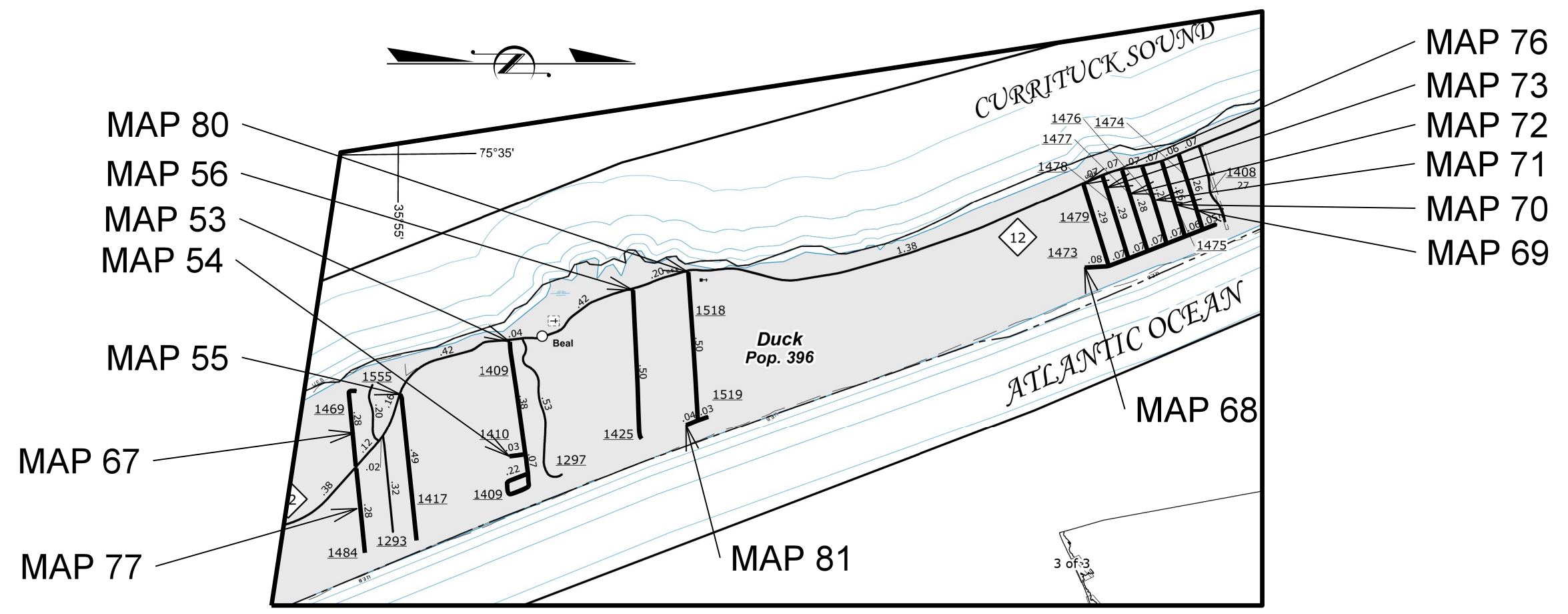

GRAPHIC SCALES

NTS

PROJECT LENGTH	
MAP 53 = 0.67 MILES	MAP 71 = 0.27 MILES
MAP 54 = 0.05 MILES	MAP 72 = 0.28 MILES
MAP 55 = 0.50 MILES	MAP 73 = 0.29 MILES
MAP 56 = 0.52 MILES	MAP 76 = 0.29 MILES
MAP 67 = 0.28 MILES	MAP 77 = 0.30 MILES
MAP 68 = 0.50 MILES	MAP 80 = 0.50 MILES
MAP 69 = 0.26 MILES	MAP 81 = 0.07 MILES
MAP 70 = 0.26 MILES	

Prepared in the Office of:
DIVISION OF HIGHWAYS
 113 Airport Dr., Edenton NC, 27932

2018 STANDARD SPECIFICATIONS

W. B. HOBBS, PE
 DIVISION PROJECT TEAM LEAD

C. E. SLACHTA
 DIVISION PROPOSALS ENGINEER

S. P. FENWICK, PLS
 DIVISION DESIGN ENGINEER

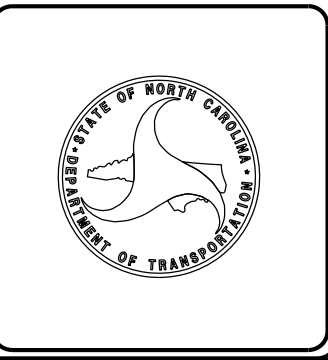

15-OCT-2021 08:07
 S:\Contracts\6) Proposed Resurfacing\DA00516-Cracksealing\Design Files\2022CPT.01.12.10482.1.DIDDC_sh7.dgn
 \$\$\$USERNAME\$\$\$

CONTRACT: DA00516 **WBS#: 2022CPT.01.12.10082.1, ETC.**

STATE OF NORTH CAROLINA
 DIVISION OF HIGHWAYS

HYDE COUNTY

LOCATION: MAP 10 US 264 FROM SR 1315 TO DARE CO LINE
TYPE OF WORK: CRACKSEALING

STATE	STATE PROJECT REFERENCE NO.	SHEET NO.
N.C.	2022CPT.01.12.10082.1, ETC.	7
STATE PROJ. NO.	F.A. PROJ. NO.	DESCRIPTION
2022CPT.01.12.10482.1		PE, CONST.

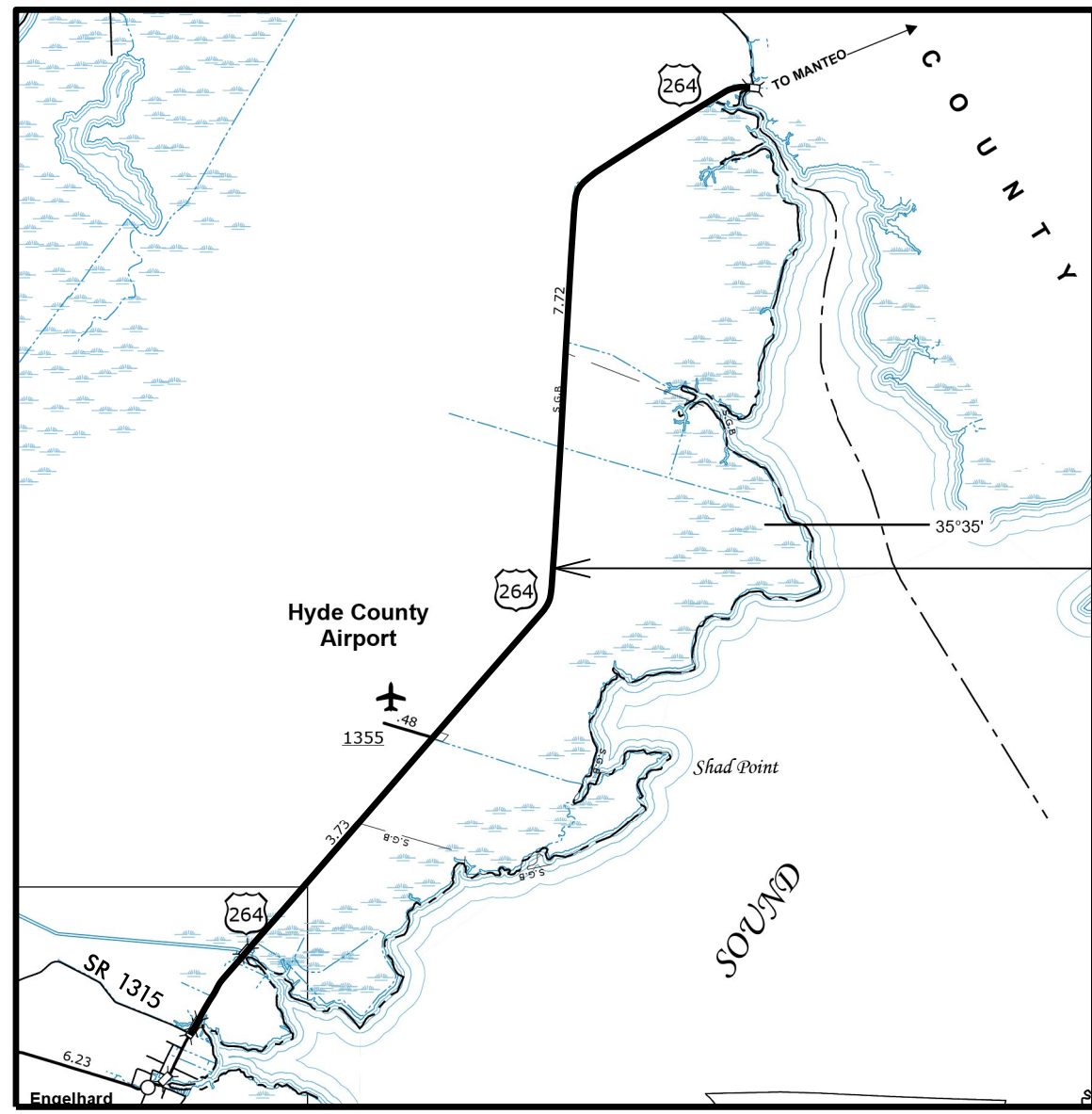

GRAPHIC SCALES

NTS

PROJECT LENGTH

LENGTH OF ROADWAY MAP 10 = 11.42 MILES

Prepared In the Office of:
DIVISION OF HIGHWAYS
 113 Airport Dr., Edenton NC, 27932

2018 STANDARD SPECIFICATIONS

W. B. HOBBS, PE
 DIVISION PROJECT TEAM LEAD

C. E. SLACHTA
 DIVISION PROPOSALS ENGINEER

S. P. FENWICK, PLS
 DIVISION DESIGN ENGINEER

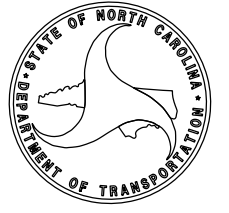

STATE	STATE PROJECT REFERENCE NO.	SHEET NO.
N.C.	2022CPT.01.12.10082.1, ETC.	8
STATE PROJ. NO.	F.A. PROJ. NO.	DESCRIPTION
2022CPT.01.12.10582.1		PE, CONST.

STATE OF NORTH CAROLINA
DIVISION OF HIGHWAYS

MARTIN COUNTY

LOCATION: MAP 11 - NC 125 FROM NC 11 TO NC 903
MAP 12 - NC 125 FROM HALIFAX COUNTY TO NC 11

TYPE OF WORK: CRACKSEALING

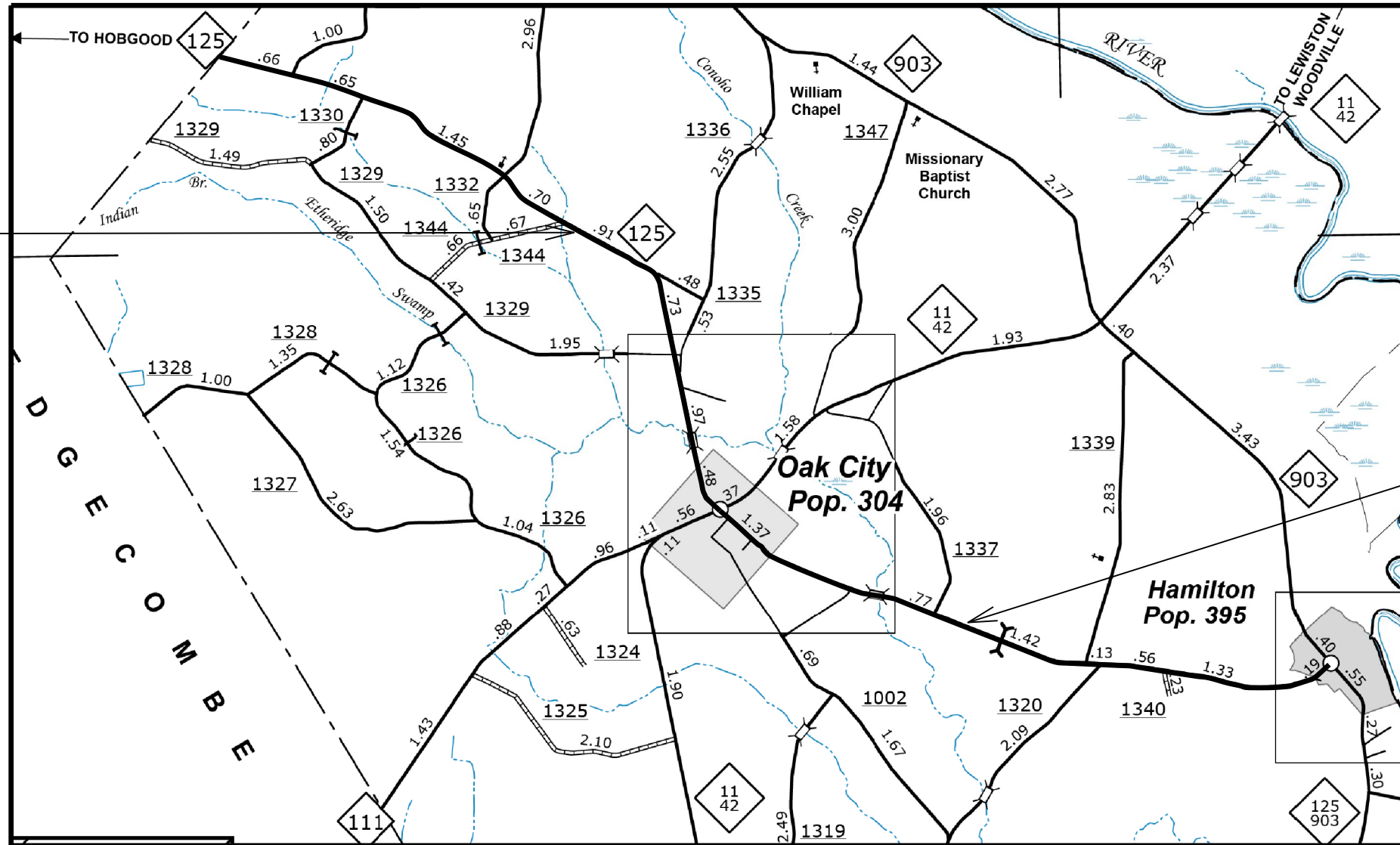

MAP 12

MAP 11

CONTRACT: DA00516 WBS#: 2022CPT.01.12.10082.1, ETC.

15-OCT-2021 08:02 S:\Contracts\6\Proposed Resurfacing\DA00516-Cracksealing\Design Files\2022CPT.01.12.10582.1.DIDDC_sn8.dgn \$\$\$USERNAME\$\$\$

GRAPHIC SCALES

NTS

PROJECT LENGTH

LENGTH OF ROADWAY MAP 11 = 5.83 MILES
LENGTH OF ROADWAY MAP 12 = 6.58 MILES

Prepared in the Office of:
DIVISION OF HIGHWAYS
113 Airport Dr., Edenton NC, 27932

2018 STANDARD SPECIFICATIONS

W. B. HOBBS, PE
DIVISION PROJECT TEAM LEAD

C. E. SLACHTA
DIVISION PROPOSALS ENGINEER

S. P. FENWICK, PLS
DIVISION DESIGN ENGINEER

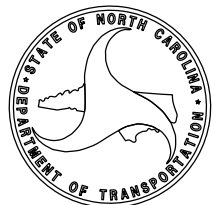

19-OCT-2021 09:45
 S:\Contracts\6\Proposed Resurfacing\DA00516-Cracksealing\Design Files\2022CPT.01.12.10702.1.DIDDc_srh9.dgn
 \$\$\$USERNAME\$\$\$

CONTRACT: DA00516 **WBS#: 2022CPT.01.12.10082.1, ETC.**

STATE OF NORTH CAROLINA
DIVISION OF HIGHWAYS

STATE	STATE PROJECT REFERENCE NO.	SHEET NO.
N.C.	2022CPT.01.12.10082.1, ETC.	9
STATE PROJ. NO.	F.A. PROJ. NO.	DESCRIPTION
2022CPT.01.12.10702.1		PE, CONST.
2022CPT.01.12.20702.1		PE, CONST.

TYPE OF WORK: CRACKSEALING

PASQUOTANK COUNTY

LOCATION:

- MAP 13 – US 158 FROM GATES CO LINE TO US 17
- MAP 96 – SR 1182 FROM SR 1100 TO SR 1101
- MAP 97 – SR 1210 FROM DEAD END TO SR 1100
- MAP 98 – SR 1259 FROM SR 1275 TO SR 1139
- MAP 99 – SR 1302 FROM SR 1300 TO SR 1144
- MAP 100 – SR 1417 FROM CAMDEN CO LINE TO US 158

- MAP 101 – SR 1450 FROM CUL-DE-SAC TO SR 1140
- MAP 102 – SR 1451 FROM DEAD END TO SR 1453
- MAP 103 – SR 1452 FROM SR 1453 TO SR 1451
- MAP 104 – SR 1453 FROM SR 1456 TO SR 1450
- MAP 105 – SR 1454 FROM CUL-DE-SAC TO SR 1456
- MAP 106 – SR 1455 FROM SR 1461 TO SR 1461
- MAP 107 – SR 1456 FROM SR 1374 TO SR 1461
- MAP 108 – SR 1457 FROM SR 1461 TO SR 1456
- MAP 109 – SR 1458 FROM CUL-DE-SAC TO SR 1457
- MAP 110 – SR 1459 FROM CUL-DE-SAC TO SR 1457
- MAP 111 – SR 1460 FROM SR 1300 TO SR 1461
- MAP 112 – SR 1461 FROM SR 1456 TO SR 1453
- MAP 113 – SR 1463 FROM CUL-DE-SAC TO SR 1456

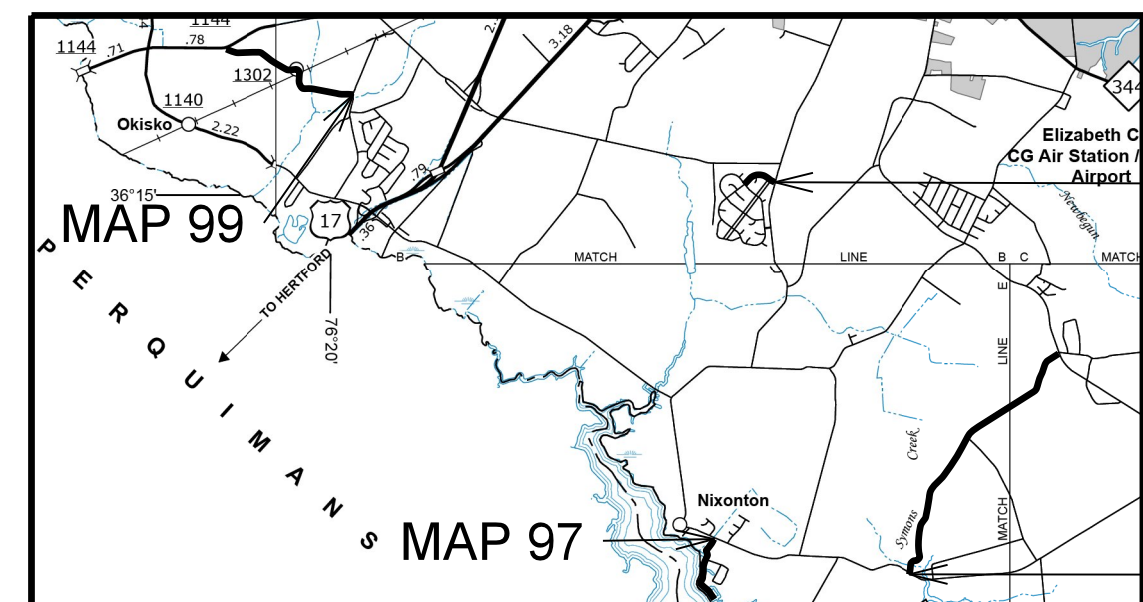
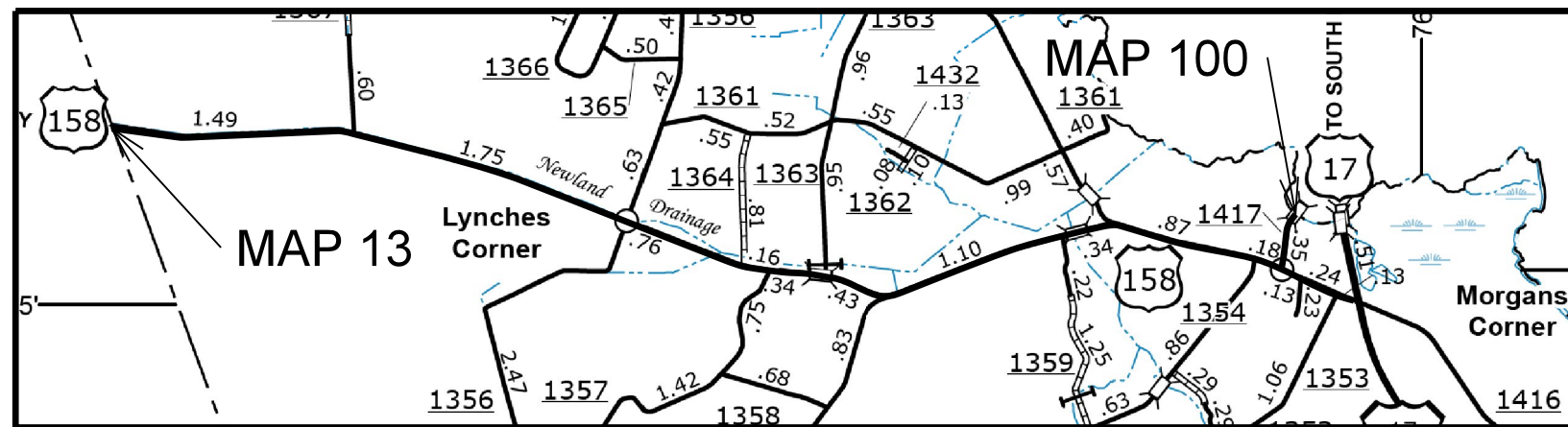

- MAP 108
- MAP 110
- MAP 109
- MAP 111
- MAP 113
- MAP 106
- MAP 101
- MAP 102

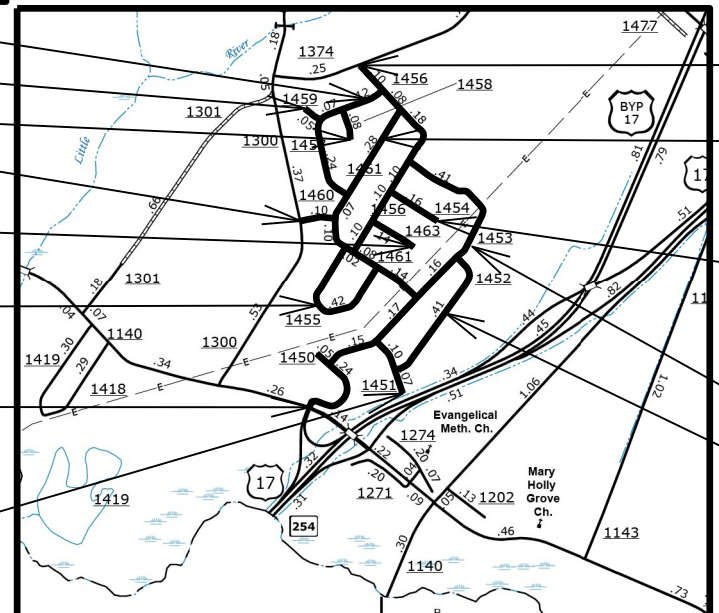

- MAP 107
- MAP 112
- MAP 105
- MAP 104
- MAP 103

GRAPHIC SCALES

NTS

PROJECT LENGTH	
MAP 13 = 8.08 MILES	MAP 105 = 0.15 MILES
MAP 96 = 2.84 MILES	MAP 106 = 0.42 MILES
MAP 97 = 0.69 MILES	MAP 107 = 0.66 MILES
MAP 98 = 0.35 MILES	MAP 108 = 0.43 MILES
MAP 99 = 1.50 MILES	MAP 109 = 0.08 MILES
MAP 100 = 0.35 MILES	MAP 110 = 0.05 MILES
MAP 101 = 0.28 MILES	MAP 111 = 0.10 MILES
MAP 102 = 0.17 MILES	MAP 112 = 0.68 MILES
MAP 103 = 0.41 MILES	MAP 113 = 0.13 MILES
MAP 104 = 0.88 MILES	

Prepared in the Office of:
DIVISION OF HIGHWAYS
113 Airport Dr., Edenton NC, 27932

2018 STANDARD SPECIFICATIONS

W. B. HOBBS, PE
DIVISION PROJECT TEAM LEAD

C. E. SLACHTA
DIVISION PROPOSALS ENGINEER

S. P. FENWICK, PLS
DIVISION DESIGN ENGINEER

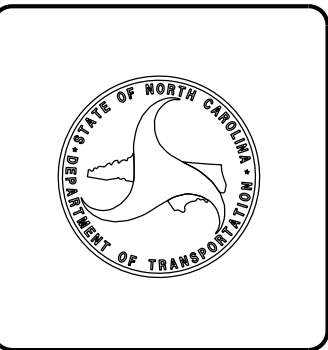

15-OCT-2021 07:47
 S:\Contracts\6) Proposed Resurfacing\DA00516-Cracksealing\Design Files\2022CPT.01.12.10892.1.DIDDC_snl0.dgn
 \$\$\$USERNAME\$\$\$

CONTRACT: DA00516 **WBS#: 2022CPT.01.12.10082.1, ETC.**

STATE OF NORTH CAROLINA
 DIVISION OF HIGHWAYS

TYRRELL COUNTY

LOCATION: MAP 14 - NC 94 FROM HYDE COUNTY LINE TO SR 1300

TYPE OF WORK: CRACKSEALING

STATE	STATE PROJECT REFERENCE NO.	SHEET NO.
N.C.	2022CPT.01.12.10082.1, ETC.	10
STATE PROJ. NO.	F.A. PROJ. NO.	DESCRIPTION
2022CPT.01.12.10892.1		PE, CONST.

MAP 14

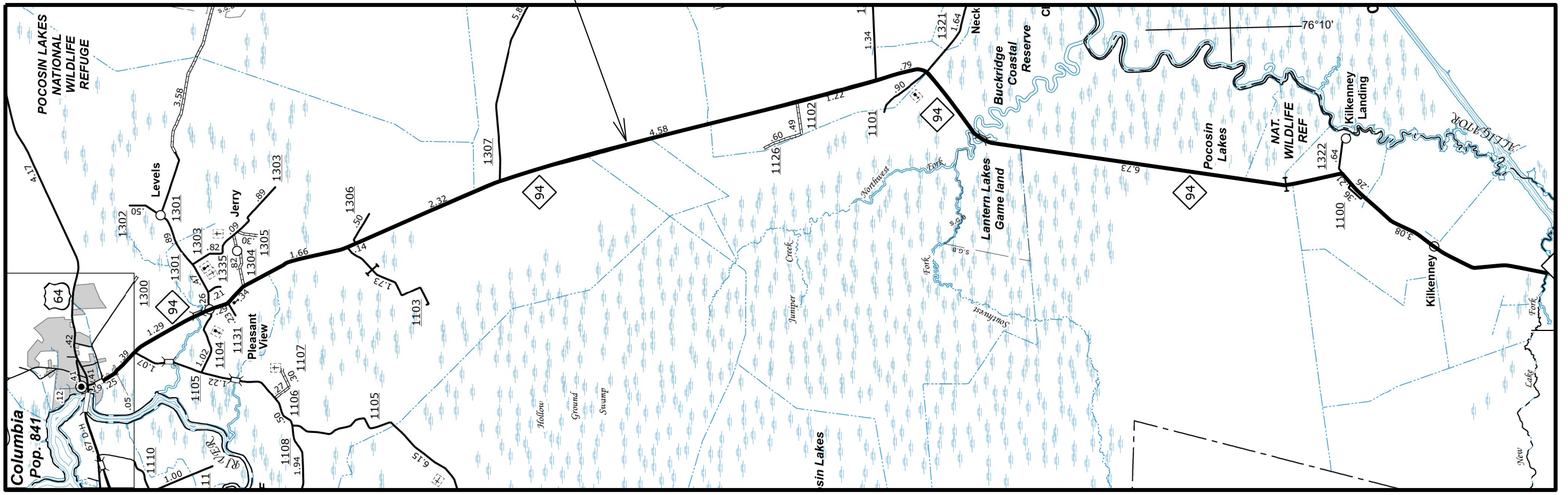

GRAPHIC SCALES

NTS

PROJECT LENGTH

 LENGTH OF ROADWAY MAP 14 = 23.57 MILES

Prepared in the Office of:
DIVISION OF HIGHWAYS
 113 Airport Dr., Edenton NC, 27932

2018 STANDARD SPECIFICATIONS

W. B. HOBBS, PE
 DIVISION PROJECT TEAM LEAD

C. E. SLACHTA
 DIVISION PROPOSALS ENGINEER

S. P. FENWICK, PLS
 DIVISION DESIGN ENGINEER

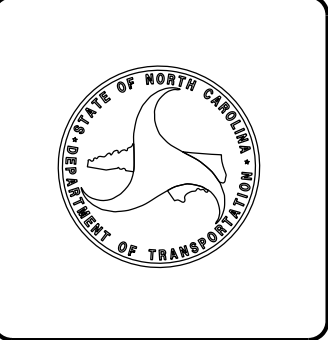

09/08/99

WBS#:2022CPT.01.12.10082.1, ETC.
CONTRACT:DA00516

STATE OF NORTH CAROLINA
DIVISION OF HIGHWAYS

GATES COUNTY

STATE	STATE PROJECT REFERENCE NO.	SHEET NO.
N.C.	2022CPT.01.12.10082.1, ETC.	11
STATE PROJ. NO.	F.A. PROJ. NO.	DESCRIPTION
2022CPT.01.12.20372.1		PE, CONST.

TYPE OF WORK: CRACKSEALING

LOCATION: MAP 90 - SR 1117 FROM SR 1118 TO SR 1114
MAP 91 SR 1215 FROM NC 37 TO US 13
MAP 92 SR 1303 FROM SR 1300 TO NC 37
MAP 93 SR 1319 FROM SR 1318 TO US 158
MAP 94 SR 1321 FROM SR 1320 TO US 158
MAP 95 SR 1336 FROM SR 1002 TO US 158

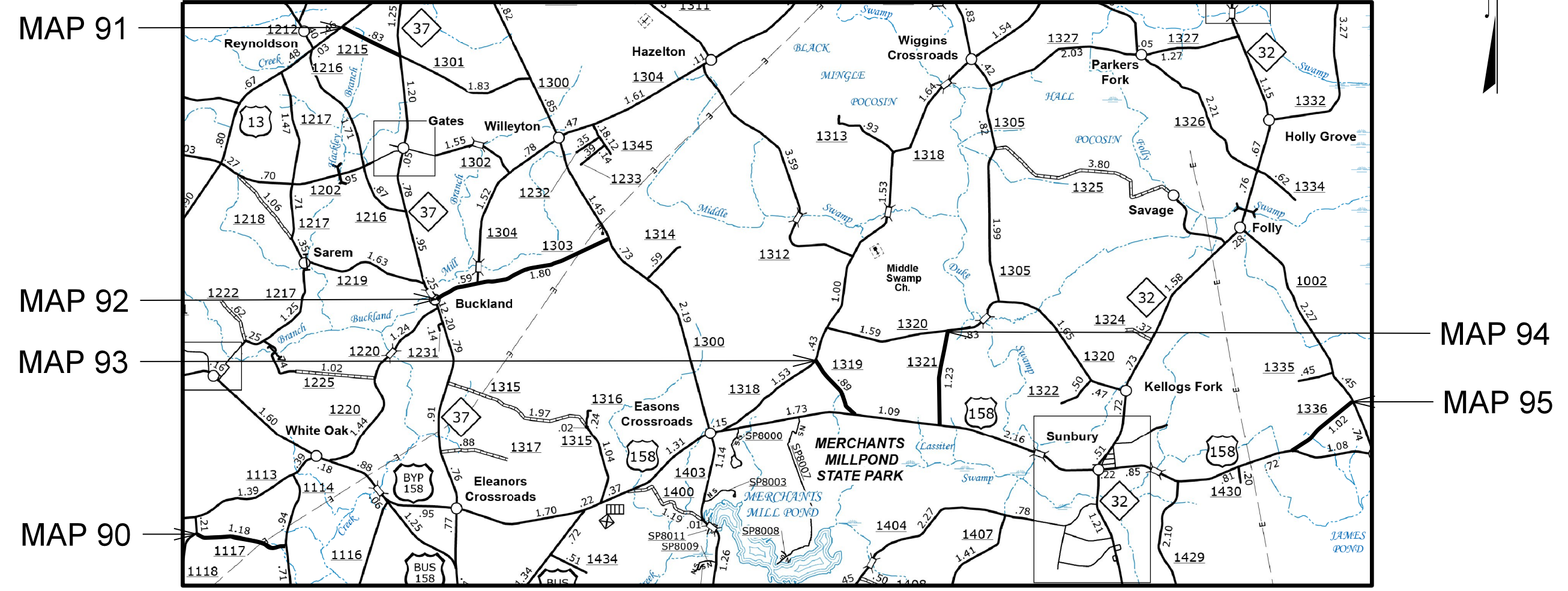

GRAPHIC SCALES

NTS

PROJECT LENGTH

LENGTH OF ROADWAY MAP 90 = 1.18 MILES
 LENGTH OF ROADWAY MAP 91 = 0.83 MILES
 LENGTH OF ROADWAY MAP 92 = 2.39 MILES
 LENGTH OF ROADWAY MAP 93 = 0.89 MILES
 LENGTH OF ROADWAY MAP 94 = 1.23 MILES
 LENGTH OF ROADWAY MAP 95 = 1.02 MILES

Prepared in the Office of:
DIVISION OF HIGHWAYS
 113 Airport Dr., Edenton NC, 27932

2018 STANDARD SPECIFICATIONS

W. B. HOBBS, PE
 DIVISION PROJECT TEAM LEAD

C. E. SLACHTA
 DIVISION PROPOSALS ENGINEER

S. P. FENWICK, PLS
 DIVISION DESIGN ENGINEER

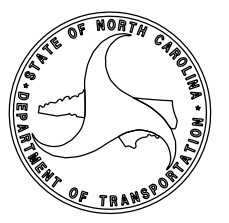

14-OCT-2021 08:36
\\2022CPT_01_12_20372_1_DIDDC_snil.dgn
\$\$\$\$\$USERNAME\$\$\$\$\$

STATE	STATE PROJECT REFERENCE NO.	SHEET NO.
N.C.	2022CPT.01.12.10082.1, ETC.	12
STATE PROJ. NO.	F.A. PROJ. NO.	DESCRIPTION
2022CPT.01.12.20722.1		PE, CONST.

STATE OF NORTH CAROLINA
DIVISION OF HIGHWAYS

PERQUIMANS COUNTY

LOCATION: MAP 114 – SR 1222 FROM SR 1223 TO SR 1221
MAP 115 – SR 1300 FROM SR 1303 TO SR 1329
MAP 116 – SR 1332 FROM DEAD END TO SR 1329
MAP 117 – SR 1352 FROM DEAD END TO SR 1336
MAP 118 – SR 1391 FROM SR 1301 TO SR 1416

TYPE OF WORK: CRACKSEALING

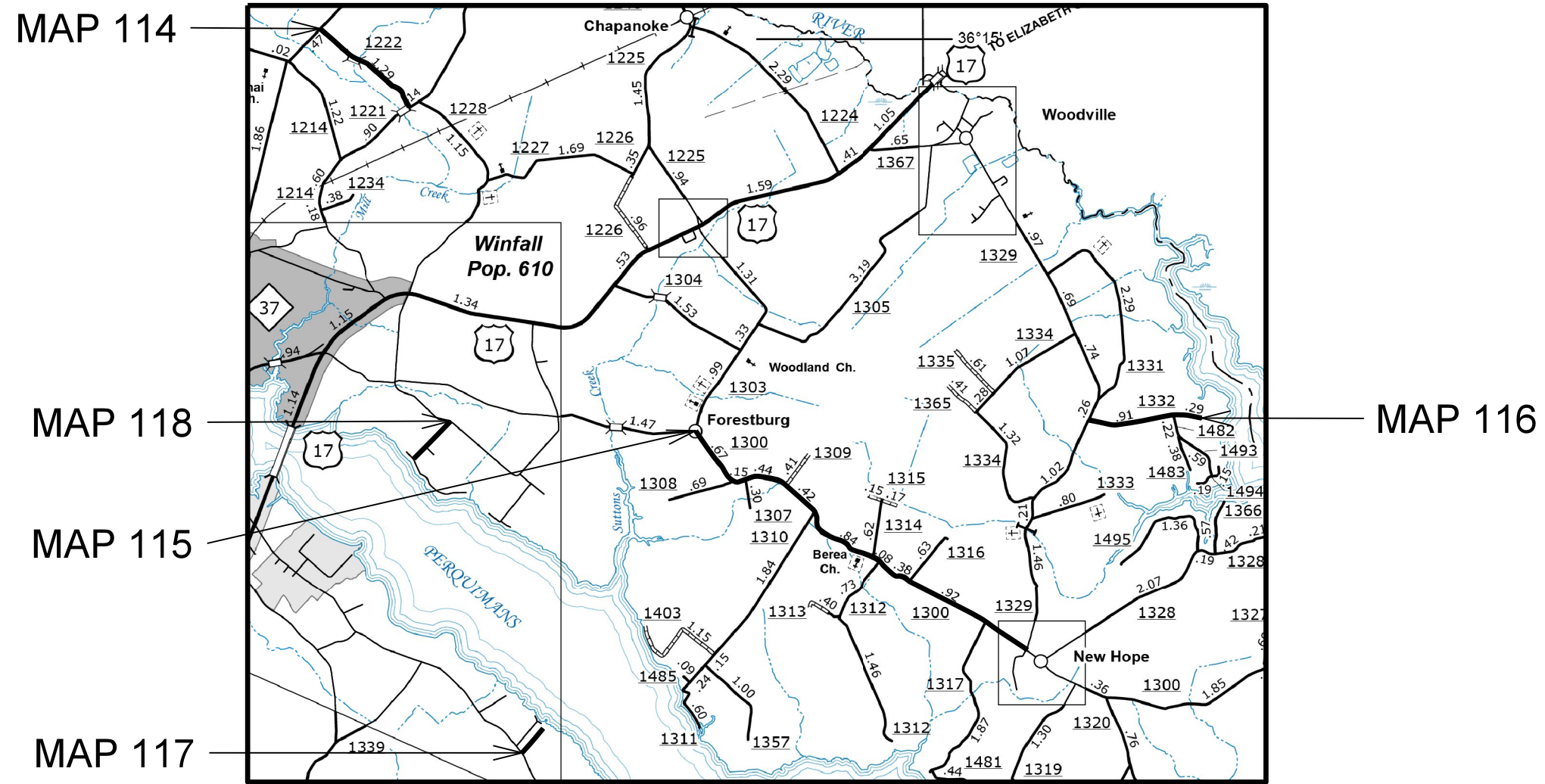

WBS#: 2022CPT.01.12.10082.1, ETC.

CONTRACT: DA00516

14-OCT-2021 08:29 S:\Contracts\6) Proposed Resurfacing\DA00516-Cracksealing\Design Files\2022CPT.01.12.20722.1.DIDD.C...sh12.dgn \$\$\$USERNAME\$\$\$

GRAPHIC SCALES

NTS

PROJECT LENGTH

LENGTH OF ROADWAY MAP 114 =	1.29 MILES
LENGTH OF ROADWAY MAP 115 =	4.39 MILES
LENGTH OF ROADWAY MAP 116 =	1.40 MILES
LENGTH OF ROADWAY MAP 117 =	0.35 MILES
LENGTH OF ROADWAY MAP 118 =	0.56 MILES

Prepared in the Office of:
DIVISION OF HIGHWAYS
113 Airport Dr., Edenton NC, 27932

2018 STANDARD SPECIFICATIONS	
	W. B. HOBBS, PE <small>DIVISION PROJECT TEAM LEAD</small>
	C. E. SLACHTA <small>DIVISION PROPOSALS ENGINEER</small>

S. P. FENWICK, PLS
DIVISION DESIGN ENGINEER

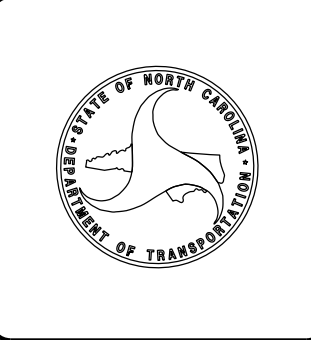

NOTES:

* CRACK SEALING MATERIAL SHALL CONSIST OF TYPE 2 PS/AR HOT POURED RUBBER ASPHALT

TYPICAL PAVEMENT CRACK

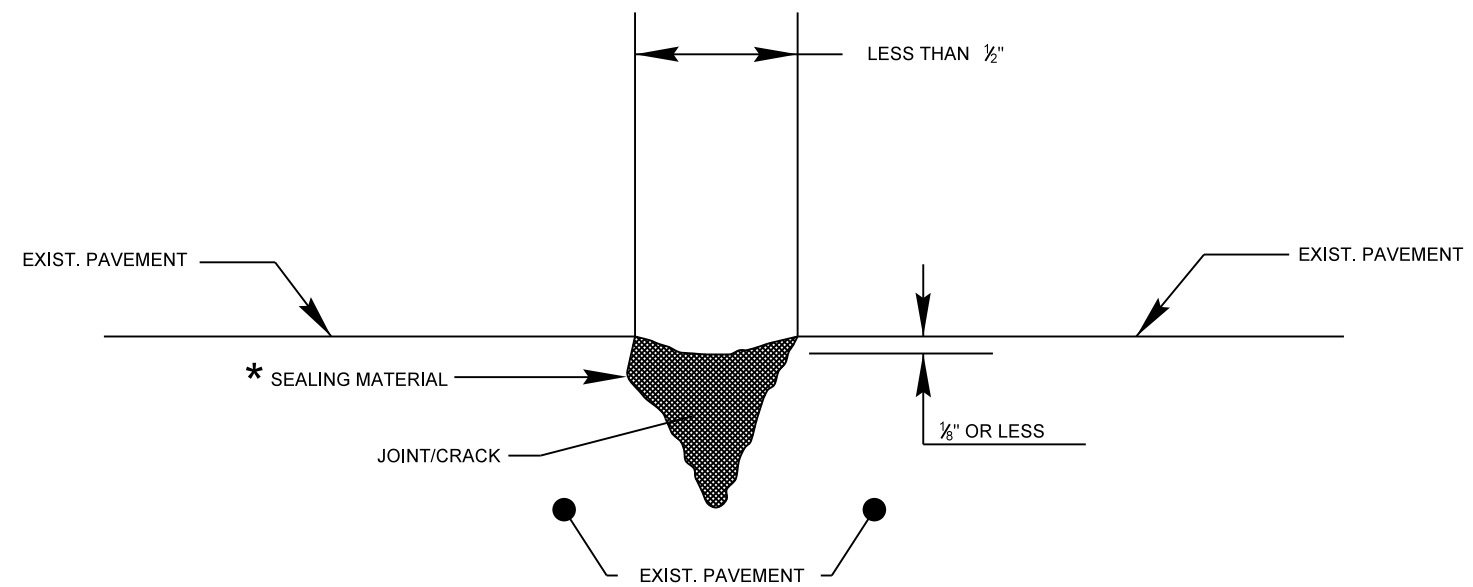

TYPICAL SECTION NO. 1

USE WITH: ALL MAPS

